

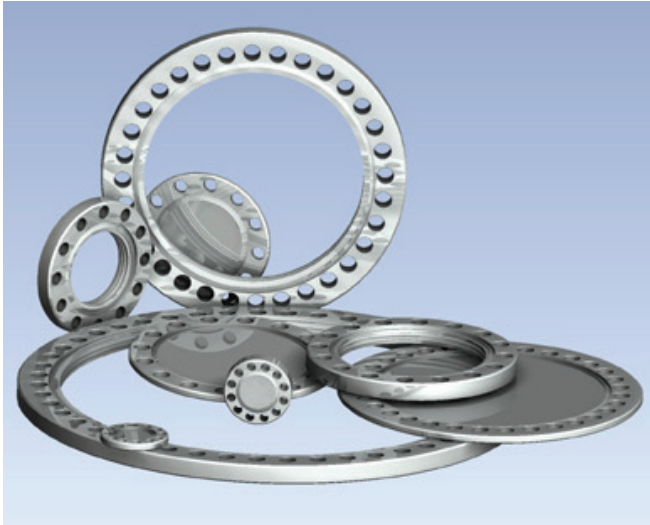

THIN FLANGE Multi-CF™ FITTING

1 1/3 CF TO 8 CF UHV FLANGES FOR CUSTOM IN-VACUUM MOUNTING ADD GROOVE GRABBER TECHNOLOGY TO EXISTING SYSTEMS

PATENT PENDING



Thin Flanges, solid or with open bore, two thicknesses with or without Grabber Grooves

APPLICATIONS:

IN-VACUUM CUSTOM MOUNTING
ADAPTS COMMON FEEDTHROUGHS TO
GROOVE-GRABBER TECHNOLOGY

FEATURES / OPTIONS:

SOLID FLANGE OR COMMON DIAMETER OPEN BORE
ATTACHES TO MOST MANUFACTURERS FEEDTHROUGHS
THIN LENGTH FOR REDUCED SYSTEM SIZE

THE MCF THIN FLANGE

The Thin Flange is a new type of UHV CF flange, designed for in-vacuum mounting which can be inserted between two common CF style flanges from almost any manufacturer. The standard flanges provide the bending resistance necessary to have a uniform crushing force along the gasket perimeter. The forces on the Thin Flange are symmetric. The gasket crushing bolts pass through the Thin Flange without putting any force on it. Thus, the Thin Flange does not experience any bending moments, and has no required thickness to prevent bending.

The Thin Flanges come in 1 1/3 CF, 2 3/4 CF, 4 1/2 CF, 6 CF and 8 CF sizes. The Thin Flange can either have an open bore, or can be solid to allow the flange to be machined for mounting holes or a custom-sized aperture. Thin Flanges with Grabber Grooves can be added to an existing vacuum system to allow the use of Groove Grabber technology. The gasket to gasket length is thin to keep the overall system compact. Two thicknesses are available: 0.175 inch and 0.400 inch. The 0.400 inch open bore flanges include one pair of Grabber Grooves on the 2 3/4 CF or larger sizes; the 0.175 inch flanges can not include Grabber Grooves.

	MCF133-TnFI2	MCF275-TnFI200	MCF450-TnFI20000	MCF600-TnFI200000	MCF800-TnFI2000000
Multi-CF FITTING	Thin Flange				
COMMON APPLICATION	In-vacuum mounting, Solid or open bore flange				
CONSTRUCTION / MATERIAL	Unitary Stainless Steel 316				
CF SEALING SURFACES	Two 1 1/3 inch CF with (12) 8-32 clear bolt holes	Two 2 3/4 inch CF with (12) 1/4-28 clear bolt holes, plus one pair of Grabber Grooves on 0.4 inch open	Two 4 1/2 inch CF with (16) 5/16-24 clear bolt holes, plus one pair of Grabber Grooves on 0.4 inch open	Two 6 inch CF with (32) 5/16-24 clear bolt holes, plus one pair of Grabber Grooves on 0.4 inch open	Two 8 inch CF with (40) 5/16-24 clear bolt holes, plus one pair of Grabber Grooves on 0.4 inch open
BORE DIAMETER	0.640 inch	1.500 inch	2.900 inch	4.300 inch	6.300 inch
LENGTH GASKET TO GASKET	0.175 or 0.400 inch	0.175 or 0.400 inch	0.175 or 0.400 inch	0.175 or 0.400 inch	0.400 inch

